

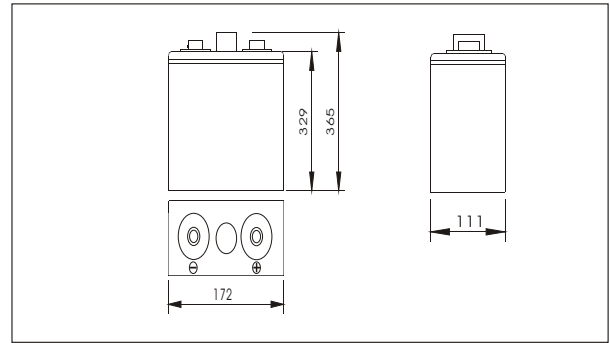

SW22000E(2V200AH)



Outer dimensions (mm)



Specifications

Nominal Voltage	2 V	
Rated capacity (10 hour rate)	200 AH	
Dimensions	Total Height	365 mm (14.4 inches)
	Height	329 mm (13.0 inches)
	Length	172 mm (6.77 inches)
	Width	111 mm (4.37 inches)
Weight Approx	13.6 Kg (30.0 lbs)	

Terminal Type (mm)

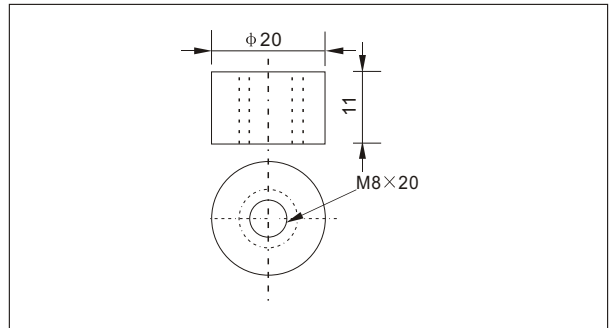

Characteristics

Capacity 25°C(77°F)	10 hour rate(20 A)	200 AH
	5 hour rate(32A)	160 AH
	1 hour rate(110 A)	110 AH
	1.5 hour discharge to 1.75 V	80 A
Internal Resistance	Full charged Battery at 25°C(77°F)	1.5 mΩ
Capacity affected by Temperature (10hour rate)	40°C(104°F)	102%
	25°C(77°F)	100%
	0°C(32°F)	85%
	-15°C(5°F)	65%
Self-Discharge at 25°C(77°F)	Capacity after 3 month storage	91%
	Capacity after 6 month storage	82%
	Capacity after 12 month storage	64%
Terminal	T20	
Charge (constant Voltage)	Cycle	Initial Charging Current less than 50 A Voltage 2.35-2.40V
	Float	Voltage 2.25-2.30V

Discharge Curves 25°C(77°F)

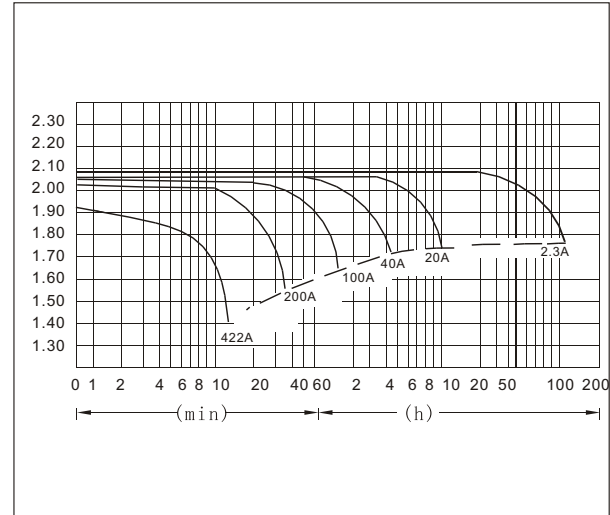

Constant Current(Amp) and Constant Power(Watt) Discharge Table at 25°C(77°F)

Time		10min	30min	1h	3h	4h	5h	8h	10h	20h	50h	100h
1.60V	A	422	228	120	51.4	40.0	33.0	23.3	21.0	11.34	4.7	2.4
	W	781	407	232	99	77	64	45	41	21.9	9.4	4.8
1.70V	A	410	222	112.8	50.0	39.0	32.4	22.8	20.5	11.06	4.6	2.4
	W	751	403	218	97	75	63	44	40	21.3	9.0	4.7
1.75V	A	392	211	109	48.8	38.4	32.0	22.6	20.0	10.92	4.5	2.3
	W	728	381	211	94	74	62	44	39	21.1	8.9	4.6
1.80V	A	366	204	106	47.6	37.8	31.2	22.0	19.5	10.80	4.4	2.3
	W	700	366	202	92	73	61	43	39	21.0	8.7	4.5
1.85V	A	336	188	99	46.0	36.7	30.4	21.4	19.00	10.26	4.3	2.2
	W	688	363	196	91	72	60	42	38	20.3	8.6	4.4