



SW6770W(6V770Ah)



Specifications

Nominal Voltage	6V	
CAPACITY(15 minutes rate to 1.67V/cell)	770W	
Rated capacity (10 hour rate)	200Ah	
Dimensions	Total Height	229 mm (9.02 inches)
	Height	224 mm (8.93 inches)
	Length	323 mm (12.7 inches)
	Width	178 mm (7.01 inches)
Weight Approx	31.5 Kg (69.3 lbs)	

Characteristics

Capacity 25°C(77°F)	30min rate	1392W
	15min rate	2310W
	5min rate	4076W
Internal Resistance	Full charged Battery at 25°C(77°F)	1.5 mΩ
Capacity affected by Temperature (20hour rate)	40°C(104°F)	102%
	25°C(77°F)	100%
	0°C(32°F)	85%
	-15°C(5°F)	65%
Self-Discharge at 25°C(77°F)	Capacity after 3 month storage	91%
	Capacity after 6 month storage	82%
	Capacity after 12 month storage	64%
Terminal	T10、T19	
Charge (constant Voltage)	Cycle	Initial Charging Current less than 40A Voltage 7.05-7.20V
	Float	Voltage 6.75-6.90V

Constant power discharge :watts(25°C, 77 F)

	5min	10min	15min	20min	30min	45min	60min	90min
4.8V	4076	3049	2363	1947	1452	1069	838	623
5.0V	3902	2950	2310	1914	1419	1030	818	602
5.1V	3728	2838	2257	1868	1393	1016	799	581
5.25V	3557	2772	2198	1835	1366	983	766	554
5.4V	3383	2482	1947	1703	1214	878	693	532
5.55V	3013	2218	1769	1571	1129	825	651	506

Outer dimensions (mm)

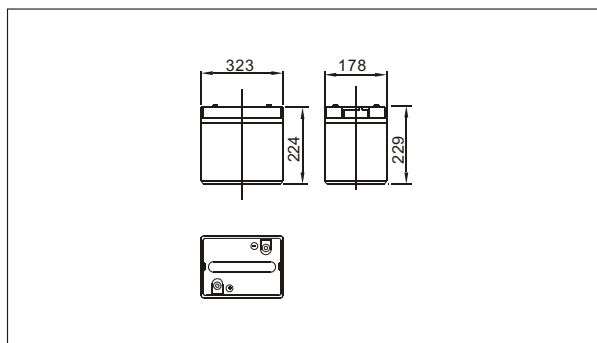

Terminal Type (mm)

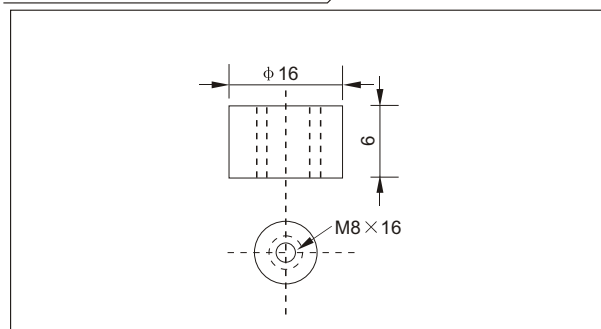

Discharge Curves 25 °C(77°F)

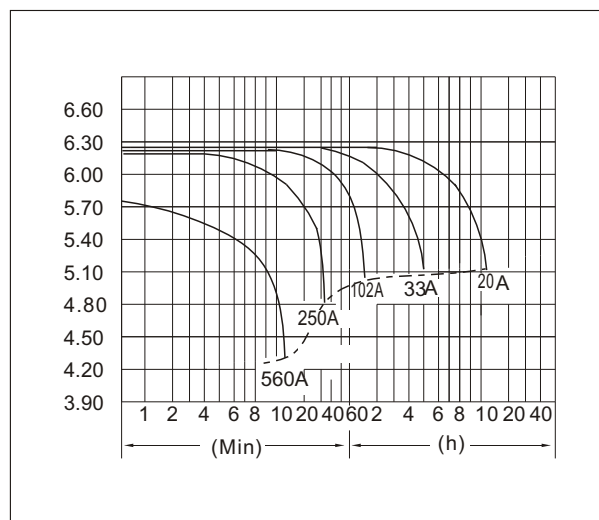

Constant current discharge unit:A(25°C, 77 F)

	5min	15min	30min	45min	60min	90min	5h	10h
4.8V	755.3	435.7	266.6	194.9	152.2	112.9	33.6	21.9
5.0V	715.3	418.3	255.8	184.9	145.4	107.1	33.3	21.5
5.1V	665.2	403.2	247.1	180.8	140.7	102.5	33.0	21.0
5.25V	615.1	377.1	229.8	166.0	128.3	96.2	32.5	20.0
5.4V	586.5	333.8	207.6	150.0	118.1	90.2	32.2	19.8
5.55V	515.0	305.6	193.8	140.7	110.8	85.6	31.5	19.3